

The student engagement survey can be accessed via google forms at :

<https://docs.google.com/forms/d/1b6M4rXbgdcYMmi1cbM1wljpLt-gyByyv-2RsDG-2BLk/edit?usp=sharing>

This toolkit contains this document (instructions on how to use the survey), a video introduction to the survey, and a powerpoint explaining the importance of engagement in the secondary education classrooms.

References and contact information are at the end of this document.

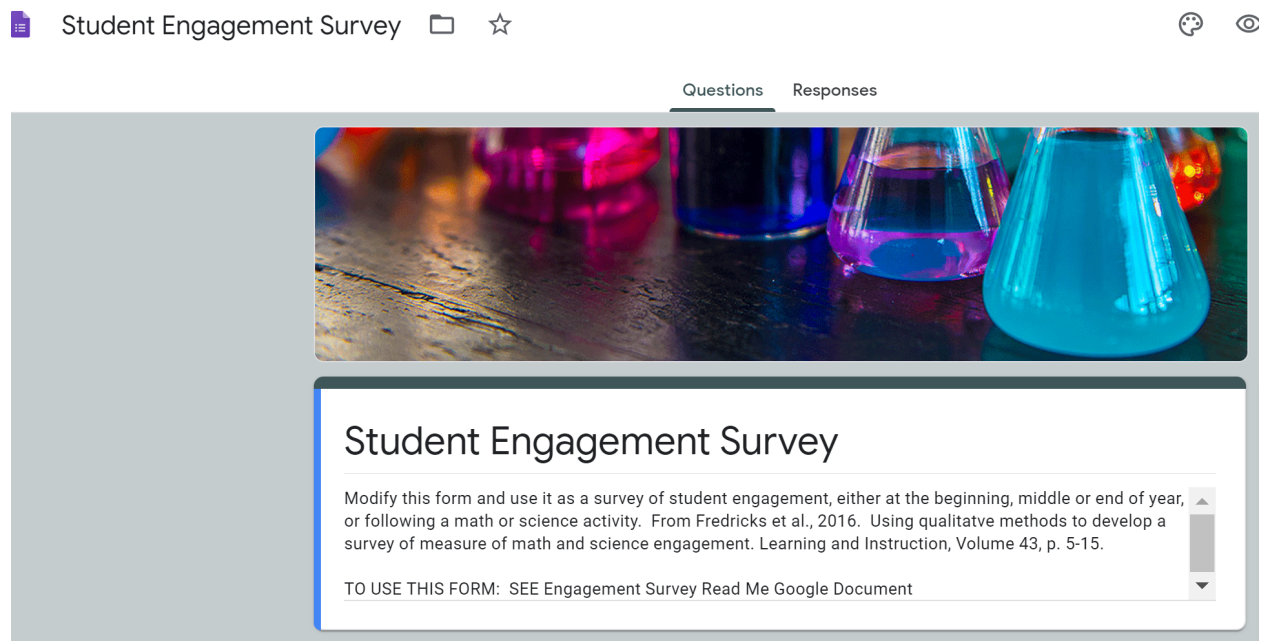

The screenshot shows a Google Forms interface. At the top, the title 'Student Engagement Survey' is displayed next to a folder icon and a star icon. On the right side, there are icons for a smiley face and an eye. Below the title, there are two tabs: 'Questions' and 'Responses'. The main content area features a header image of laboratory glassware (flasks and beakers) containing colored liquids. Below the image, the title 'Student Engagement Survey' is repeated. A text box contains the following text: 'Modify this form and use it as a survey of student engagement, either at the beginning, middle or end of year, or following a math or science activity. From Fredricks et al., 2016. Using qualitative methods to develop a survey of measure of math and science engagement. Learning and Instruction, Volume 43, p. 5-15.' Below this text box, there is a line of text: 'TO USE THIS FORM: SEE Engagement Survey Read Me Google Document'.

PLEASE be sure to do the following before using the survey:

Click the 3 dots (1), and choose “Make a copy” (2) to save the survey to your drive.

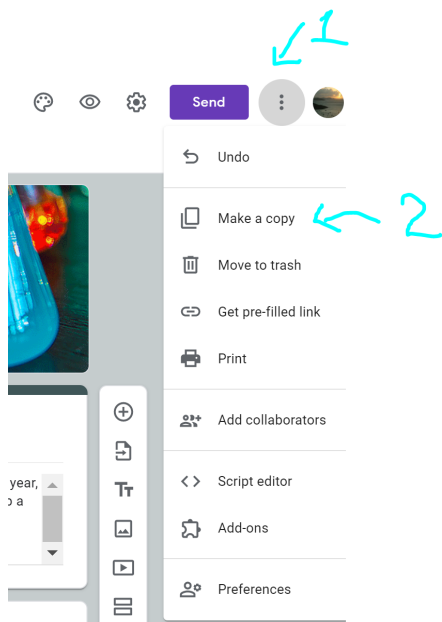

To Distribute the survey, select SEND and copy/paste the link:

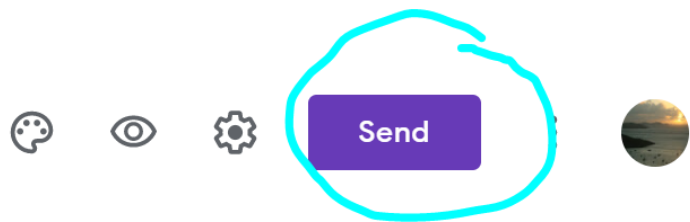

ies



Analyzing your results:

B = Behavioral engagement

E=Emotional Engagement

C=Cognitive Engagement

S=Social Engagement

Click on the responses tab:

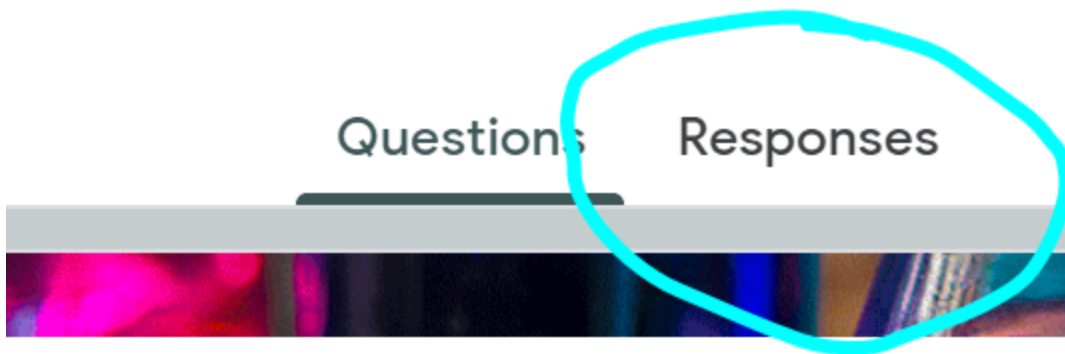

Then Click create spreadsheet:



For each group of responses, you can create an average for each student (type =average(and then highlight cells)

This will give you an index to compare that student's engagement for that specific type to a future response. (So each student should have an index for behavioral engagement, emotional engagement, cognitive engagement and social engagement.)

Questions? Email acompton@miami.edu

This toolkit was designed by Angela Compton for the SEALED data repository.

Full citation for the research used to create this survey:

Fredricks, J.A., Wang, M., Linn, J.S., Hofkens, T.L., Sung, H., Parr, A., and Allerton, J. (2016). Using qualitative methods to develop a survey measure of math and science engagement. *Learning and Instruction, 43*, p. 5-15.